

Transfer Panels

For Food, Dairy, Beverages, and Cosmetics

- Applications** Finished or raw products
Bulk ingredients
CIP routing
- Options** Proximity switches
Electropolished ports and jumpers
Customer-specified connections
Custom labeling
- Mountings** Pipe legs
Flush wall mounts
Recessed wall mounts
Pre-piped enclosure

Ask about documentation options

Transfer process fluids through multiple process lines within a piping system without worrying about cross-contamination



Tel. : (450) 686-6663

www.halesoninc.com

info@halesoninc.com

Design

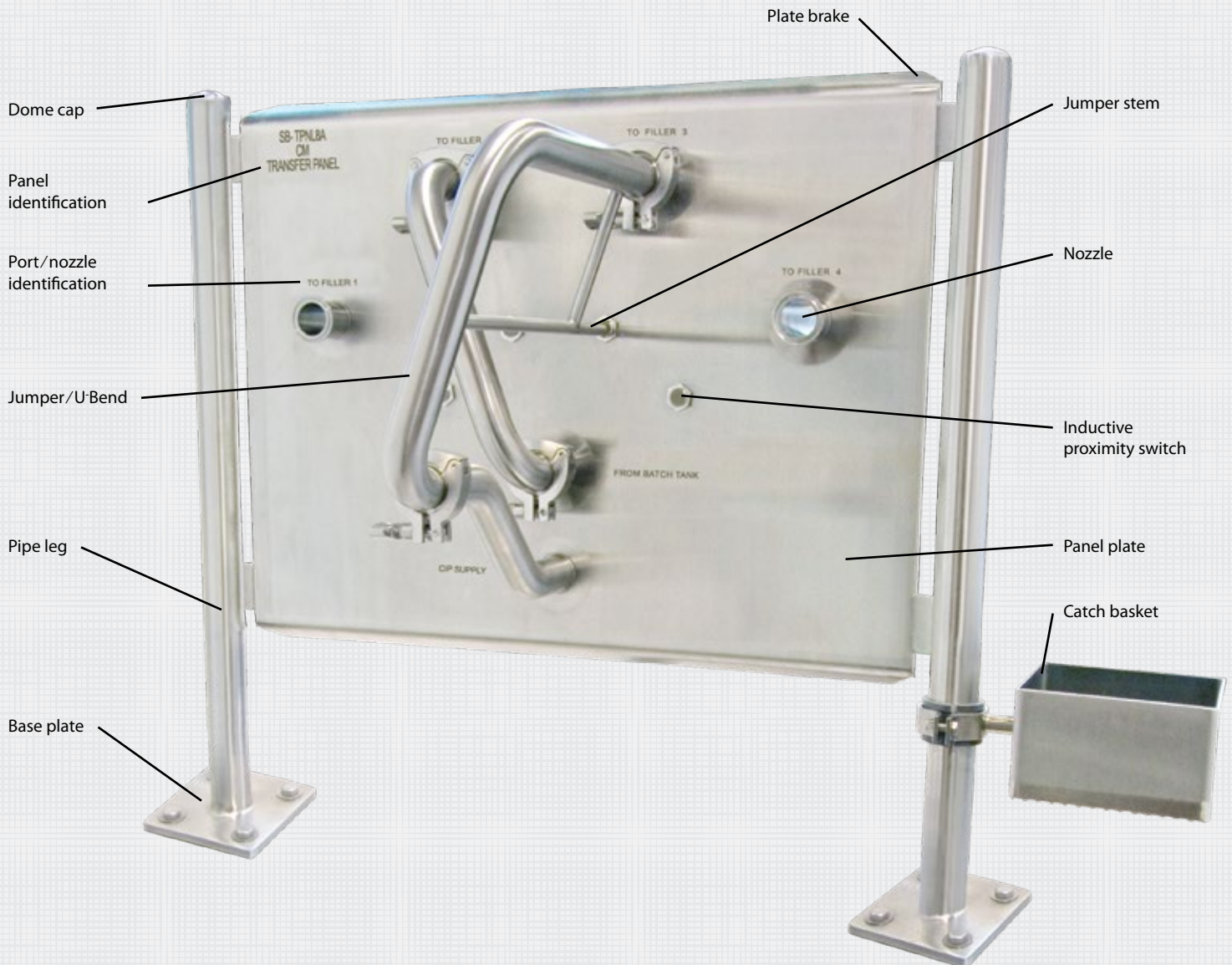

Features and Benefits

| | |
|----------------------------|--|
| Base plate | Anchors the panel to the floor – 1/2" thick for extra structural rigidity, continuously fillet welded to pipe legs, and fully ground and polished to provide a hygienic finish. |
| Catch basket | Provides a place for operator to temporarily store caps, clamps, and gaskets that are not in use. Contains a screen floor for drainage. |
| Dome cap | Eliminates a flat surface, preventing fluid and soil buildup on pipe legs. |
| Inductive proximity switch | Provides an electronic signal to the control system, indicating the ports connected by the jumper/u-bend. The standard shielded inductive proximity switch is the ifm efector IGT203. This switch features a short stainless steel cylindrical housing, extended sensing range, UL and CE compliance, 360° LED status indication, and a micro quick-connect for ease of maintenance. |
| Jumper stem | The rod-like design establishes a presence that activates a shielded inductive proximity switch, which penetrates the panel plate. |
| Jumper/U-bend | Connects to panel nozzles and enables product to be transferred from one nozzle to another. |
| Nozzle | The nozzle is seal welded to the panel. This hygienic seal weld eliminates cracks, crevices, and the possibility of product entrapment. |
| Panel identification | Identifies the transfer panel assembly. |
| Panel plate | Provides structural rigidity to uphold the required ferrule face flatness tolerances on all panel nozzles. Standard plate is 1/4" thick. |
| Pipe leg | Polished pipe is continuously fillet welded to both sides of the panel to provide extra rigidity to the panel structure. These welds are fully ground and polished to provide a hygienic finish. Pipe legs without base plates are core-drill ready. |
| Plate brake | Incorporates additional structural rigidity into larger panel plates. The 60° brake eliminates a flat surface, preventing fluid and soil buildup. |
| Port/nozzle identification | Identifies the particular service associated with each panel nozzle. Common types of port tags include: Lectroetch, Phenolic, and Pin Stamp. (Lectroetch is shown.) |

Options

| | |
|-----------------------------|---|
| Pre-piping | Include piping, manifolds, valves, and instrumentation all into one packaged unit, which minimizes the number of field-welded connections. |
| Structural mounting | Integrate tabs between the pipe legs and panel plate, or use tabs as a standalone mounting option. |
| Magnetic proximity switches | Magnetic proximity switches eliminate panel penetrations, which may contribute to entrapment and/or sterility concerns. The standard magnetic proximity switch is ifm effector MGT200. All the same features exist with the magnetic switch as with the inductive switch. |
| Other finishes | A multitude of surface finishes can be provided to meet any process requirements. Glass bead is a common finish when weld discoloration must be removed and a uniform satin finish for surface aesthetics is required. |

Transfer Panels

For Food, Dairy, Beverages, and Cosmetics

Dimensions

Standard Configurations

| TRANSFER PANEL PORT LAYOUT | Size 1 ½ | | | Size 2 | | | Size 2 ½ | | | Size 3 | | |
|-------------------------------|----------|----|-----|--------|----|----|----------|----|-----|--------|----|----|
| | A | B | CL | A | B | CL | A | B | CL | A | B | CL |
| 2 Line | 6 | 12 | 4 ½ | 6 | 12 | 6 | 8 | 16 | 7 ½ | 8 | 16 | 9 |
| 3 Triangle | 12 | 12 | 4 ½ | 12 | 12 | 6 | 16 | 16 | 7 ½ | 16 | 16 | 9 |
| 3 Around 1 | 12 | 12 | 4 ½ | 16 | 12 | 6 | 16 | 16 | 7 ½ | 20 | 16 | 9 |
| 4 Square | 12 | 12 | 4 ½ | 12 | 12 | 6 | 16 | 16 | 7 ½ | 16 | 16 | 9 |
| 4 Diamond | 12 | 12 | 4 ½ | 12 | 16 | 6 | 16 | 20 | 7 ½ | 20 | 24 | 9 |
| 4 Around 1 | 12 | 12 | 4 ½ | 16 | 16 | 6 | 20 | 20 | 7 ½ | 24 | 24 | 9 |
| 6 Rectangle | 14 | 10 | 4 ½ | 18 | 12 | 6 | 22 | 14 | 7 ½ | 26 | 16 | 9 |
| 6 Around 1 | 12 | 12 | 4 ½ | 16 | 16 | 6 | 20 | 20 | 7 ½ | 24 | 24 | 9 |
| 8 Double Square | 20 | 10 | 4 ½ | 24 | 12 | 6 | 28 | 14 | 7 ½ | 34 | 16 | 9 |
| 8 Around 1 | 12 | 12 | 4 ½ | 16 | 16 | 6 | 20 | 20 | 7 ½ | 24 | 24 | 9 |

All dimensions are shown in inches. Custom layouts are available.
Panels with a "B" dimension of 20" or more will have three tabs per side.

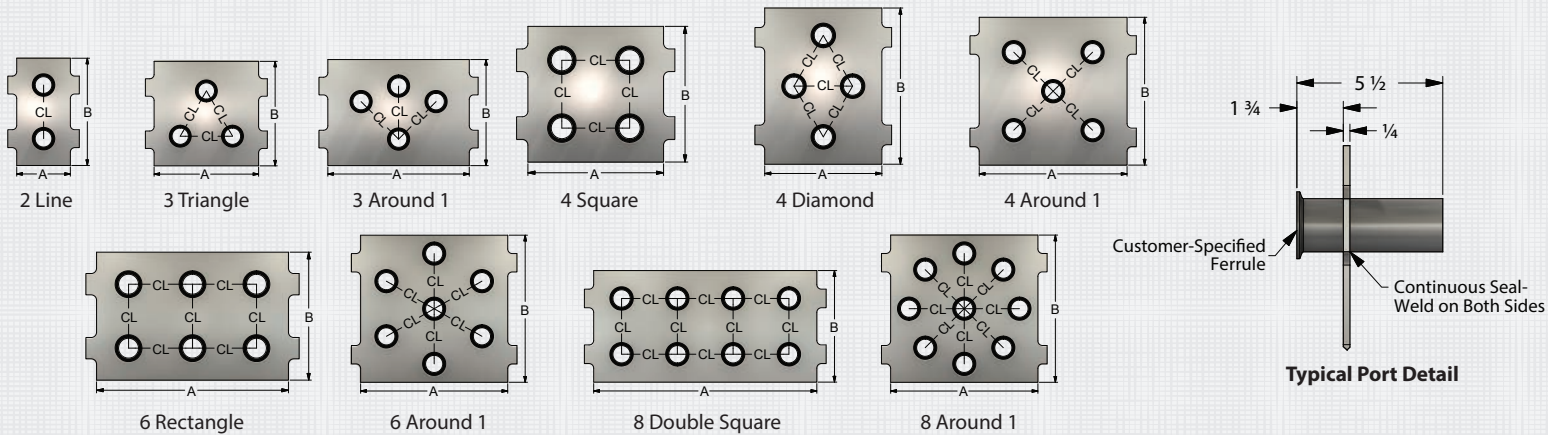

Jumper Options

| TUBE SIZE | A |
|-----------|-----|
| 1 ½ | 4 ½ |
| 2 | 6 |
| 2 ½ | 7 ½ |
| 3 | 9 |
| 4 | 12 |

All dimensions are shown in inches.

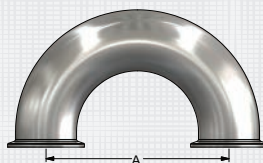

Haleson HS

Tel. : (450) 686-6663

www.halesoninc.com

info@halesoninc.com