

HS-7MP CLAMP TEE

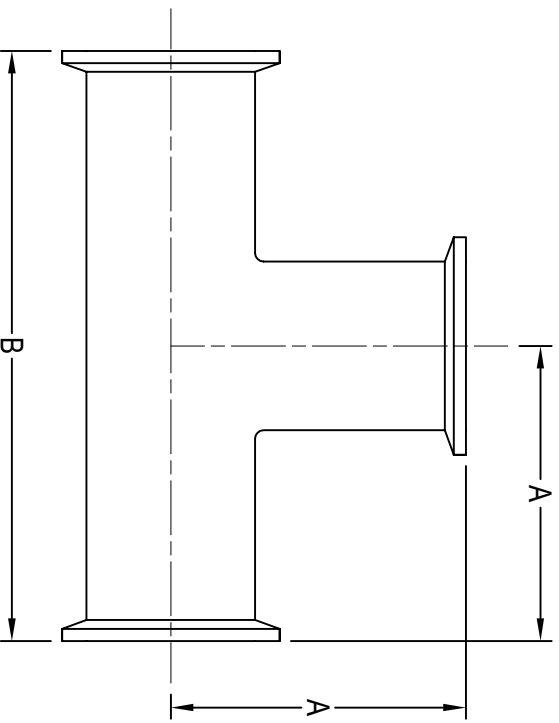

CLAMP SIZE	A	B	Wall Thickness	SS-304 Item No.	SS-316L Item No.
1/2"	2.375	4.750	0.065	0.50" HS-7MP-4-7	0.50" HS-7MP-6-7
3/4"	2.375	4.750	0.065	0.75" HS-7MP-4-7	0.75" HS-7MP-6-7
1"	2.375	4.750	0.065	1.00" HS-7MP-4-7	1.00" HS-7MP-6-7
1 1/2"	2.750	5.500	0.065	1.50" HS-7MP-4-7	1.50" HS-7MP-6-7
2"	3.500	7.000	0.065	2.00" HS-7MP-4-7	2.00" HS-7MP-6-7
2 1/2"	3.500	7.000	0.065	2.50" HS-7MP-4-7	2.50" HS-7MP-6-7
3"	3.750	7.500	0.065	3.00" HS-7MP-4-7	3.00" HS-7MP-6-7
4"	4.500	9.000	0.083	4.00" HS-7MP-4-7	4.00" HS-7MP-6-7
6"	6.500	13.000	0.109	6.00" HS-7MP-4-7	6.00" HS-7MP-6-7
8"	7.875	15.750	0.109	8.00" HS-7MP-4-7	8.00" HS-7MP-6-7
10"	9.375	18.750	0.109	10.00" HS-7MP-4-7	10.00" HS-7MP-6-7
12"	11.000	22.000	0.109	12.00" HS-7MP-4-7	12.00" HS-7MP-6-7

All dimensions in inches.

JAN. 2021



www.halesoninc.com