

HS-7RWWW REDUCING WELD TEE (SHORT)

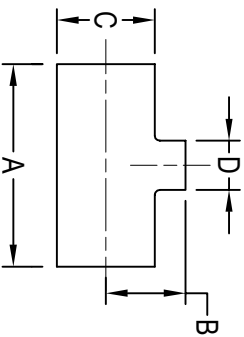

TUBE OD	A	B	C	D	Wall Thickness	SS-304 Item No.	SS-316L Item No.
3/4" x 1/2"		SEE HS-7WR(LONG) TEE				0.75" x 0.50" HS-7RWWW-4-7	0.75" x 0.50" HS-7RWWW-6-7
1" x 1/2"		SEE HS-7WR(LONG) TEE				1.00" x 0.50" HS-7RWWW-4-7	1.00" x 0.50" HS-7RWWW-6-7
1" x 3/4"		SEE HS-7WR(LONG) TEE				1.00" x 0.75" HS-7RWWW-4-7	1.00" x 0.75" HS-7RWWW-6-7
1 1/2" x 1/2"		SEE HS-7WR(LONG) TEE				1.50" x 0.50" HS-7RWWW-4-7	1.50" x 0.50" HS-7RWWW-6-7
1 1/2" x 3/4"		SEE HS-7WR(LONG) TEE				1.50" x 0.75" HS-7RWWW-4-7	1.50" x 0.75" HS-7RWWW-6-7
1 1/2" x 1"	3.312	1.375	1.500	1.000	.065	1.50" x 1.00" HS-7RWWW-4-7	1.50" x 1.00" HS-7RWWW-6-7
2" x 1/2"	5.750	2.625	2.000	.500	.065	2.00" x 0.50" HS-7RWWW-4-7	2.00" x 0.50" HS-7RWWW-6-7
2" x 3/4"	5.750	2.625	2.000	.750	.065	2.00" x 0.75" HS-7RWWW-4-7	2.00" x 0.75" HS-7RWWW-6-7
2" x 1"	4.124	1.625	2.000	1.000	.065	2.00" x 1.00" HS-7RWWW-4-7	2.00" x 1.00" HS-7RWWW-6-7
2" x 1 1/2"	4.124	1.906	2.000	1.500	.065	2.00" x 1.50" HS-7RWWW-4-7	2.00" x 1.50" HS-7RWWW-6-7
2 1/2" x 1 1/2"	4.688	2.156	2.500	1.500	.065	2.50" x 1.50" HS-7RWWW-4-7	2.50" x 1.50" HS-7RWWW-6-7
2 1/2" x 2"	4.688	2.312	2.500	2.000	.065	2.50" x 2.00" HS-7RWWW-4-7	2.50" x 2.00" HS-7RWWW-6-7
3" x 1 1/2"	5.188	2.406	3.000	1.500	.065	3.00" x 1.50" HS-7RWWW-4-7	3.00" x 1.50" HS-7RWWW-6-7
3" x 2"	5.188	2.562	3.000	2.000	.065	3.00" x 2.00" HS-7RWWW-4-7	3.00" x 2.00" HS-7RWWW-6-7
3" x 2 1/2"	5.188	2.594	3.000	2.500	.065	3.00" x 2.50" HS-7RWWW-4-7	3.00" x 2.50" HS-7RWWW-6-7
4" x 1"	6.875	2.625	4.000	1.000	.083/.065	4.00" x 1.00" HS-7RWWW-4-7	4.00" x 1.00" HS-7RWWW-6-7
4" x 1 1/2"	6.875	2.906	4.000	1.500	.083/.065	4.00" x 1.50" HS-7RWWW-4-7	4.00" x 1.50" HS-7RWWW-6-7
4" x 2"	6.875	3.062	4.000	2.000	.083/.065	4.00" x 2.00" HS-7RWWW-4-7	4.00" x 2.00" HS-7RWWW-6-7
4" x 2 1/2"	6.875	3.094	4.000	2.500	.083/.065	4.00" x 2.50" HS-7RWWW-4-7	4.00" x 2.50" HS-7RWWW-6-7
4" x 3"	6.875	3.094	4.000	3.000	.083/.065	4.00" x 3.00" HS-7RWWW-4-7	4.00" x 3.00" HS-7RWWW-6-7

All dimensions in inches.