

BPE HS-32-14MP TRI-CLAMP ECCENTRIC REDUCER (SHORT)

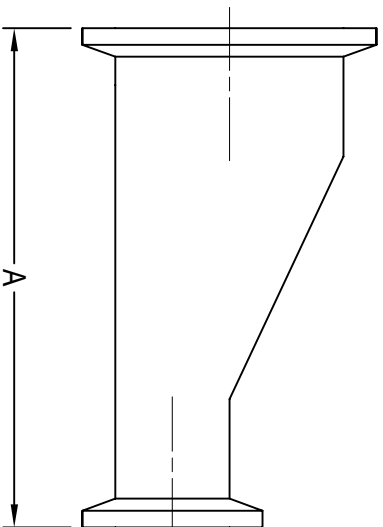

CLAMP SIZES	A	Wall Thickness	BPE SS316L Item No.
3/4" x 1/2"	2.000	0.065	0.75" x 0.50" HS-32-14MP-BS-7
1" x 1/2"	2.500	0.065	1.00" x 0.50" HS-32-14MP-BS-7
1" x 3/4"	2.000	0.065	1.00" x 0.75" HS-32-14MP-BS-7
1 1/2" x 1/2"	3.500	0.065	1.50" x 0.50" HS-32-14MP-BS-7
1 1/2" x 3/4"	3.000	0.065	1.50" x 0.75" HS-32-14MP-BS-7
1 1/2" x 1"	3.000	0.065	1.50" x 1.00" HS-32-14MP-BS-7
2" x 1/2"	5.500	0.065	2.00" x 0.50" HS-32-14MP-BS-7
2" x 3/4"	5.000	0.065	2.00" x 0.75" HS-32-14MP-BS-7
2" x 1"	5.000	0.065	2.00" x 1.00" HS-32-14MP-BS-7
2" x 1 1/2"	3.000	0.065	2.00" x 1.50" HS-32-14MP-BS-7
2 1/2" x 1 1/2"	7.500	0.065	2.50" x 0.50" HS-32-14MP-BS-7
2 1/2" x 3/4"	7.000	0.065	2.50" x 0.75" HS-32-14MP-BS-7
2 1/2" x 1"	7.000	0.065	2.50" x 1.00" HS-32-14MP-BS-7
2 1/2" x 1 1/2"	5.000	0.065	2.50" x 1.50" HS-32-14MP-BS-7
2 1/2" x 2"	3.000	0.065	2.50" x 2.00" HS-32-14MP-BS-7
3" x 1/2"	11.000	0.065	3.00" x 0.50" HS-32-14MP-BS-7
3" x 3/4"	10.000	0.065	3.00" x 0.75" HS-32-14MP-BS-7
3" x 1"	9.000	0.065	3.00" x 1.00" HS-32-14MP-BS-7
3" x 1 1/2"	7.000	0.065	3.00" x 1.50" HS-32-14MP-BS-7
3" x 2"	5.000	0.065	3.00" x 2.00" HS-32-14MP-BS-7
3" x 2 1/2"	3.000	0.065	3.00" x 2.50" HS-32-14MP-BS-7
4" x 1"	13.125	0.083 / 0.065	4.00" x 1.00" HS-32-14MP-BS-7
4" x 1 1/2"	11.125	0.083 / 0.065	4.00" x 1.50" HS-32-14MP-BS-7
4" x 2"	9.125	0.083 / 0.065	4.00" x 2.00" HS-32-14MP-BS-7
4" x 2 1/2"	7.125	0.083 / 0.065	4.00" x 2.50" HS-32-14MP-BS-7
4" x 3"	5.125	0.083 / 0.065	4.00" x 3.00" HS-32-14MP-BS-7
6" x 3"	7.500	0.109 / 0.065	6.00" x 3.00" HS-32-14MP-BS-7
6" x 4"	7.625	0.109 / 0.083	6.00" x 4.00" HS-32-14MP-BS-7

All dimensions in inches.