

BPE HS-32S-14MP TRI-CLAMP ECCENTRIC REDUCER (SHORT)

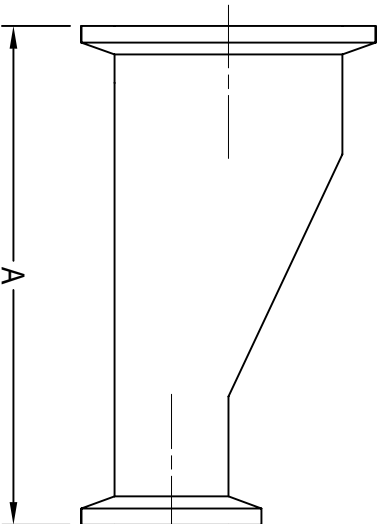

DT-4.1.3-3

| CLAMP SIZES | A | Wall Thickness | BPE SS316L Item No. |
|-----------------|-------|----------------|----------------------------------|
| 3/4" x 1/2" | 3.125 | 0.065 | 0.750" x 0.500" HS-31S-14MP-BS-7 |
| 1" x 1/2" | 3.500 | 0.065 | 1.000" x 0.500" HS-31S-14MP-BS-7 |
| 1" x 3/4" | 3.125 | 0.065 | 1.000" x 0.750" HS-31S-14MP-BS-7 |
| 1 1/2" x 3/4" | 4.000 | 0.065 | 1.500" x 0.750" HS-31S-14MP-BS-7 |
| 1 1/2" x 1" | 3.500 | 0.065 | 1.500" x 1.000" HS-31S-14MP-BS-7 |
| 2" x 1" | 4.375 | 0.065 | 2.000" x 1.000" HS-31S-14MP-BS-7 |
| 2" x 1 1/2" | 3.500 | 0.065 | 2.000" x 1.500" HS-31S-14MP-BS-7 |
| 2 1/2" x 1 1/2" | 4.375 | 0.065 | 2.500" x 1.500" HS-31S-14MP-BS-7 |
| 2 1/2" x 2" | 3.500 | 0.065 | 2.500" x 2.000" HS-31S-14MP-BS-7 |
| 3" x 1 1/2" | 5.250 | 0.065 | 3.000" x 1.500" HS-31S-14MP-BS-7 |
| 3" x 2" | 4.375 | 0.065 | 3.000" x 2.000" HS-31S-14MP-BS-7 |
| 3" x 2 1/2" | 3.625 | 0.065 | 3.000" x 2.500" HS-31S-14MP-BS-7 |
| 4" x 2" | 6.250 | 0.083 / 0.065 | 4.000" x 2.000" HS-31S-14MP-BS-7 |
| 4" x 2 1/2" | 5.375 | 0.083 / 0.065 | 4.000" x 2.500" HS-31S-14MP-BS-7 |
| 4" x 3" | 5.000 | 0.083 / 0.065 | 4.000" x 3.000" HS-31S-14MP-BS-7 |

All dimensions in inches.

JANUARY 2025



www.halesoninc.com