

BPE HS-32 WELD ECCENTRIC REDUCER (SHORT)

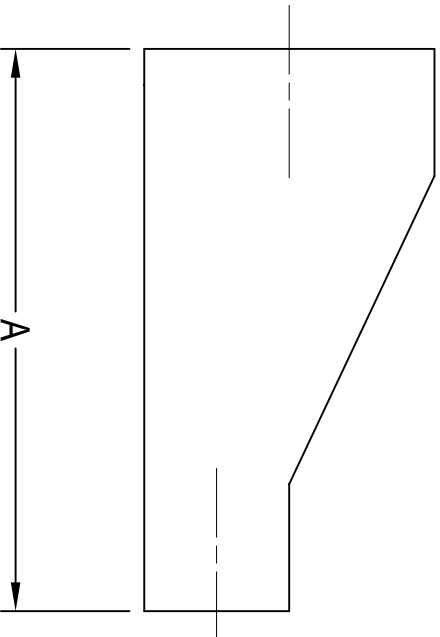

| CLAMP SIZES | A | Wall Thickness | BPE SS316L Item No. |
|-----------------|-------|----------------|-------------------------|
| 3/4" X 1/2" | 2.125 | 0.065 | 0.75" X 0.50" HS-32-B-7 |
| 1" X 1/2" | 2.500 | 0.065 | 1.00" X 0.50" HS-32-B-7 |
| 1" X 3/4" | 2.125 | 0.065 | 1.00" X 0.75" HS-32-B-7 |
| 1 1/2" X 3/4" | 3.000 | 0.065 | 1.50" X 0.75" HS-32-B-7 |
| 1 1/2" X 1" | 2.500 | 0.065 | 1.50" X 1.00" HS-32-B-7 |
| 2" X 1" | 3.375 | 0.065 | 2.00" X 1.00" HS-32-B-7 |
| 2" X 1 1/2" | 2.500 | 0.065 | 2.00" X 1.50" HS-32-B-7 |
| 2 1/2" X 1 1/2" | 3.375 | 0.065 | 2.50" X 1.50" HS-32-B-7 |
| 2 1/2" X 2" | 2.500 | 0.065 | 2.50" X 2.00" HS-32-B-7 |
| 3" X 1 1/2" | 4.250 | 0.065 | 3.00" X 1.50" HS-32-B-7 |
| 3" X 2" | 3.375 | 0.065 | 3.00" X 2.00" HS-32-B-7 |
| 3" X 2 1/2" | 2.625 | 0.065 | 3.00" X 2.50" HS-32-B-7 |
| 4" X 2" | 5.125 | 0.083 / 0.065 | 4.00" X 2.00" HS-32-B-7 |
| 4" X 2 1/2" | 4.250 | 0.083 / 0.065 | 4.00" X 2.50" HS-32-B-7 |
| 4" X 3" | 3.875 | 0.083 / 0.065 | 4.00" X 3.00" HS-32-B-7 |

DT-4.1.3-1

All dimensions in inches.

JANUARY 2025



www.halesoninc.com