

BPE HS-16AMP CLAMP SOLID END CAP

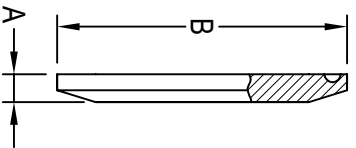

DT-4.1.5-2

CLAMP SIZE	A	B	BPE SS316L Item No.
1/2" - 3/4"	0.188	0.984	0.50"-0.75" HS-16AMP-B-7
1" - 1 1/2"	0.250	1.984	1.00"-1.50" HS-16AMP-B-7
2"	0.250	2.516	2.00" HS-16AMP-B-7
2 1/2"	0.250	3.047	2.50" HS-16AMP-B-7
3"	0.250	3.579	3.00" HS-16AMP-B-7
4"	0.312	4.682	4.00" HS-16AMP-B-7

All dimensions in inches.

JANUARY 2025



www.halesoninc.com